

NOTES: UNLESS OTHERWISE SPECIFIED:

1. INSTALLATION PRINT INTENDED SOLELY FOR USER INFORMATION TO CONCEPTUALLY DESIGN INTO VEHICLE
2. TRIPOD HOUSINGS REQUIRE USE OF SMALL TRE TRIPOD, P/N INV-02002011, PURCHASED SEPARATELY

REVISIONS				
ZONE	REV.	DESCRIPTION	DATE	APPROVED

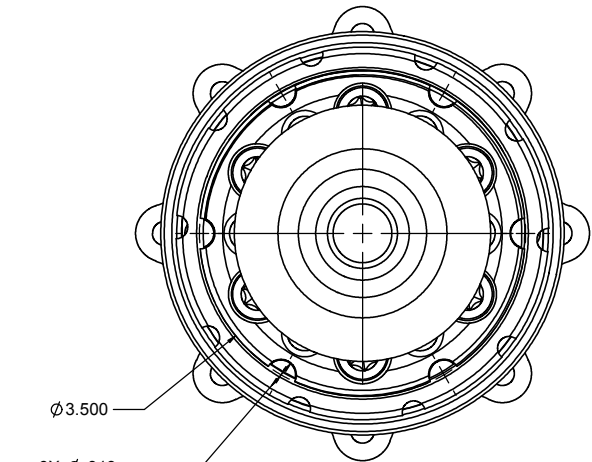

6X $\phi .313$
DRIVE PINS
FOR SPROCKET
ADAPTER

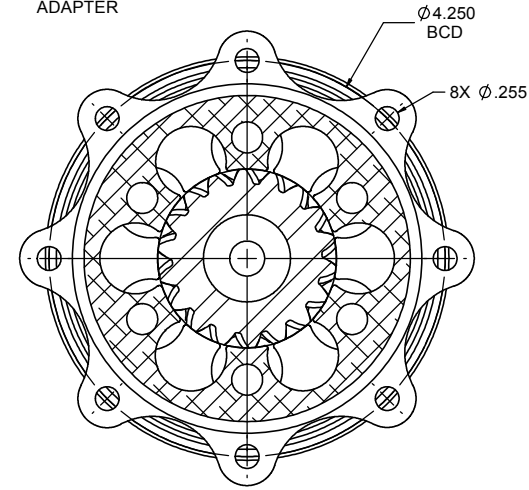

SECTION A-A

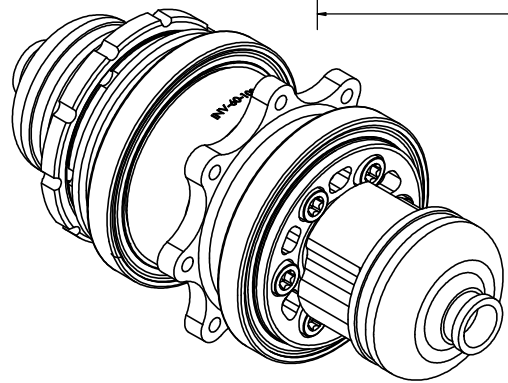

LOCKING NUT MUST BE EITHER
SAFETY WIRED OR PINNED
TO END BELL FOR
ANTI-ROTATION CONTROL

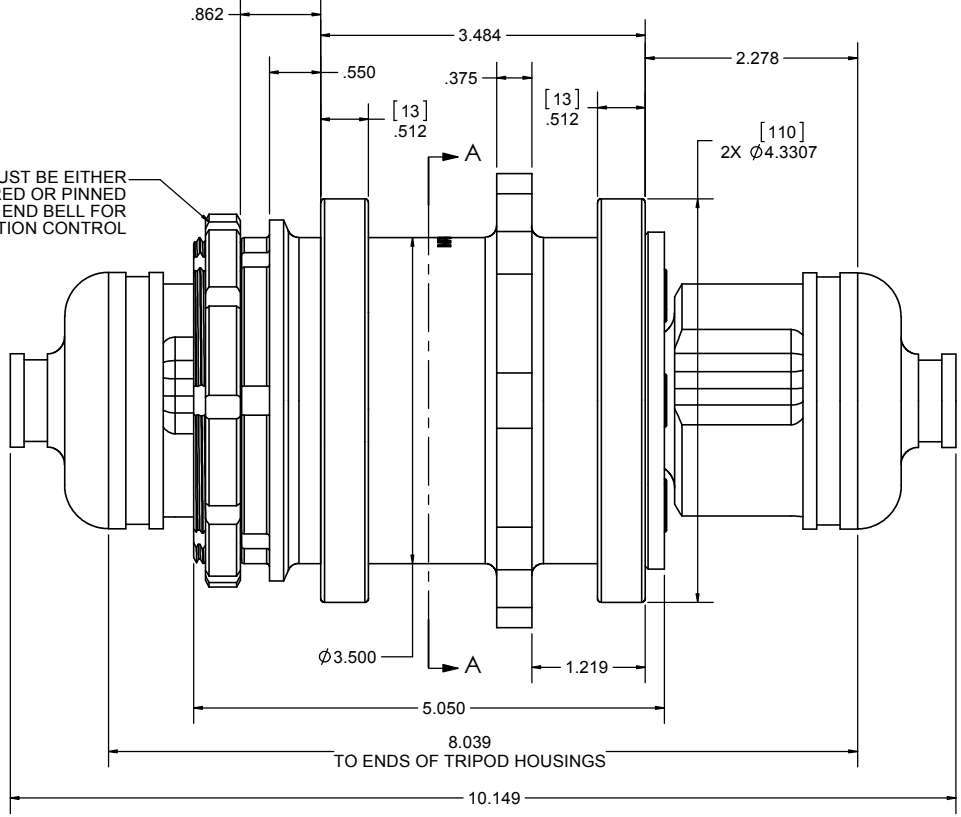

NAME	DATE
DRAWN	
CHECKED	
APPROVED	
THIRD ANGLE PROJECTION	
UNLESS OTHERWISE SPECIFIED: INTERPRET GD&T PER ASME Y14.5M-2009	
DIMENSIONS ARE IN INCHES: DIMENSIONS IN [XX] ARE MILLIMETERS BREAK ALL SHARP EDGES 0.005-0.015 RADIUS INSIDE CORNERS 0.032 MAX SURFACE TEXTURE: 63 μ m MAX	
TOLERANCES: LINEAR: ± 0.005 ANGLES: $\pm 1.0^\circ$	
MATERIAL:	
FINISH:	
DO NOT SCALE DRAWING	

Taylor
RACE ENGINEERING www.taylor-race.com

TITLE:
**TRE CHAIN DRIVE DIFF MK II
INSTALLATION PRINT**

SIZE: **B** DWG. NO. **INV-06-10008-Installation Print**

SCALE: 3:4 WEIGHT: 8.2 lbs SHEET 1 OF 1

PROPRIETARY AND CONFIDENTIAL
THE INFORMATION CONTAINED IN THIS
DRAWING IS THE SOLE PROPERTY OF
TAYLOR RACE ENGINEERING, LLC.
ANY REPRODUCTION IN PART OR AS A
WHOLE WITHOUT THE WRITTEN PERMISSION
OF TAYLOR RACE ENGINEERING, LLC IS
STRICTLY PROHIBITED.